



DERBY CITY COUNCIL



# A catalogue of trees in Derby Arboretum







# Contents

|                             |    |
|-----------------------------|----|
| Introduction                | 4  |
| How to use this booklet     | 9  |
| Area maps and lists         | 10 |
| Area A                      | 10 |
| Area B                      | 14 |
| Area C                      | 16 |
| Area D                      | 18 |
| Area E                      | 20 |
| How to find Derby Arboretum | 26 |

# Introduction

This booklet is aimed at anyone wanting to study the trees in the Derby Arboretum in more detail and complements the Tree Trail Leaflet (available from the Rangers and other places), which gives: an introduction to the history of the Arboretum; information on 25 trees picked for their historical or botanical importance.

The Derby Arboretum was the result of collaboration between two men – the benefactor, Joseph Strutt (1765-1844), and the designer, John Claudius Loudon (1783 - 1843). When the Arboretum was given to the people of Derby in 1840, a catalogue was written by Loudon (price one shilling) which listed all the trees and shrubs planted in the Arboretum and gave some detailed information on where the plant came from, its growth habit and botanical interest.

Additionally, Loudon provided lines of verse about certain species. For example, for Beech, Loudon quoted from Gray's 'Elegy':

“There at the foot of yonder nodding beech,  
That wreathes its old fantastic roots so high,  
His listless strength at noontide would he stretch,  
And pore upon the brook that babbles by.”

Loudon had completed the 'Grand Tour' of Europe and the Near East and so had seen many of the trees and shrubs that are planted in the Arboretum in their native habitat.

He was the author of several books and numerous articles on gardening, landscape design and town planning. His most significant work was the completion of '*Arboretum et fruticetum Britannicum*' which ran to several large volumes and took him eight years to write.





*Edwardian postcard of the Arboretum.*

The catalogue contained the register of trees, shrubs and climbers planted in the Arboretum and a detailed specification for the management of the grounds. He clearly stated how the trees should be mulched with leaf litter and grass cuttings, kept free from deadwood but otherwise not pruned and removed altogether when they reached a height of 40 or 50 feet (13-16 metres). Loudon appreciated that the variety of trees and shrubs could not be maintained if the larger trees were allowed to grow to their full height.

The Arboretum was meant to be a collection of trees and shrubs to maintain variety and educate the public on the horticultural merits of the plants and not to have the huge specimens you can see in the Arboretum today.

While there are many collections of trees and shrubs in Britain, (some are private), the importance of Derby Arboretum is its well documented history. It was Britain's first public park. It was specifically designed to educate and inform as well as provide a refuge from the smoke, cramped conditions and hard work in the factories and mills of the industrial Midlands.

The Arboretum is unique in that its relatively small size was enhanced by including mounds and serpentine paths to give a feeling of extra space.

By the mid-1840s, the Arboretum was a well-known tourist attraction with people coming from all over the country on the recently-completed rail network. The Rosehill playing fields were added in 1845 complete with a large glass 'crystal palace'. In the Arboretum, a fountain was constructed in 1846 and, in 1852, an orangery and entrance building complete with Strutt's statue.

One of the main problems for the collection during the Victorian era was the poor quality of the air. Many trees and shrubs died and were replaced in the 1880s with common species such as London Plane and Lime that could tolerate the pollution. These trees have grown into very large specimens and threaten to crowd out the more interesting species and also make the Arboretum rather gloomy in the summer.

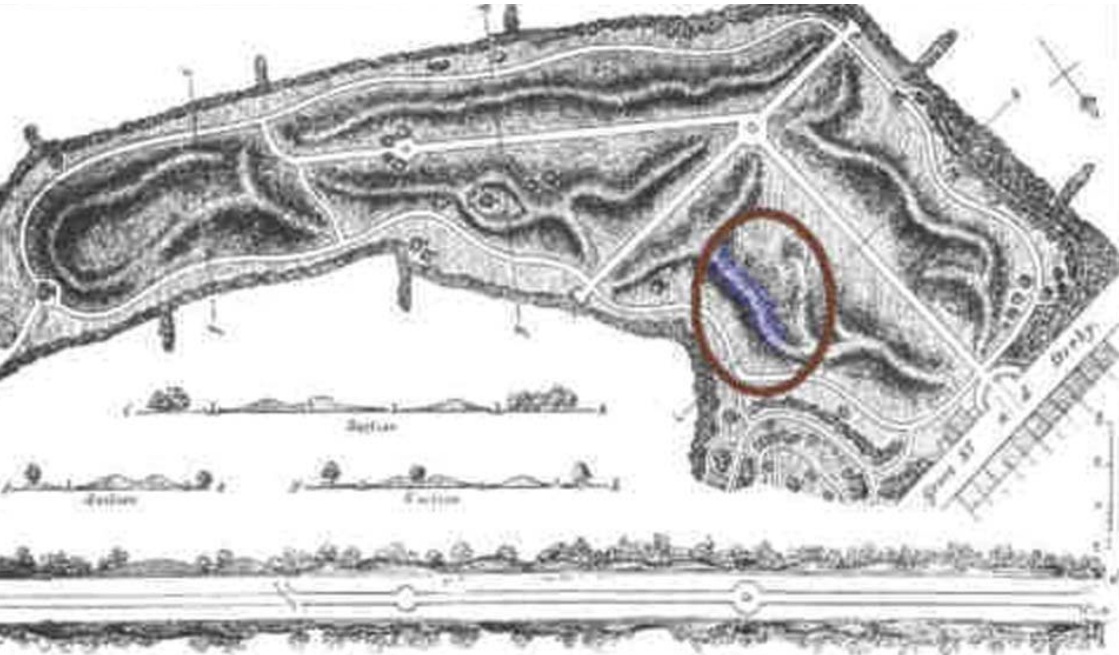

*Plan from the original catalogue showing the position of the mounds, paths and their dimensions.*

A sensible management plan would be to continue to remove some of these larger, more common species to allow the new planting of flowering and fruiting species close to the paths.

All of the following trees have labels and so it is not essential to start your tour in one place, but you may find it easier to start at the Grove Street Lodge and go anti-clockwise around the collection. This follows Loudon's original design where the trees and shrubs were laid out in their family groups.

The information for each tree is as follows:

- Family - for example: *Fagaceae* (Oaks, Beech, Sweet Chestnut)
- Genus - for example: *Quercus* (Oak)
- Species - for example: *robur* (Pedunculate Oak)

There may also be a variety such as '*Fastigiata*' (upright) or '*Variiegata*' (variegated).

The use of family, genus and species was first developed by the Swedish botanist Carl Linnaeus (1707-1778). It is known as biological classification or 'taxonomy' and aims to organise the natural world into groups that share similar characteristics. The common name is given, but it should be noted that some plants have several common names such as the hawthorn which is also known as 'May' or 'quick' which can lead to confusion. The country of origin, also known as 'provenance', is given, where relevant, but some have been grown by cuttings or grafting and so are termed 'of garden origin'.

The year of introduction is given where known. This is particularly interesting to the horticulturalist as it coincides with the 'discovery' of new countries and the natural riches they contain. So, plants from Europe and the Near East have been known in Britain for many centuries, but plants from eastern United States only became available after the 1500s, plants from western USA after 1800, China 1760 and Japan 1850. South American trees became available in the late part of the 18th century and Australian trees were unknown until the early 1800s.



*The Art Deco bandstand opened in 1935 and destroyed by fire in 1994.*

Loudon's collection was very comprehensive with over 800 different varieties of hardy trees and shrubs. He sourced them from various nurseries and also from the Royal Horticultural Society's gardens.

From its opening in 1840 until 1882, a small admission fee was charged to pay for the Arboretum's upkeep. This fee was waived on Wednesday and Sunday afternoons to allow working people and shopkeepers to use the park on their days off. The lodges were built to house the gardening staff and the pavilions were designed as shelters where visitors could enjoy their picnics. All the buildings and the pattern of mounds and pathways were illustrated in the catalogue.

Over 170 years that the Arboretum has existed, so much has happened and fashions have changed. The Arboretum has been used to house cannons from the Crimean War, aviaries, an art deco bandstand, bomb shelters and municipal greenhouses. The Arboretum is now firmly on the way up through an injection of money from the Heritage Lottery Fund, the work of dedicated staff and local volunteers. If you want to play a role in the Arboretum's future, why not join the Friends Group. The Rangers will provide you with details or you can get further information on Derby City Council's website, visit: [www.derby.gov.uk](http://www.derby.gov.uk)

*Enjoy your visit!*



# How to use this booklet

This list was produced in June 2011. It identifies all the different species in the Arboretum, so not every tree has a label. Inevitably it dates very quickly as trees are removed and new ones planted. We hope to update this list on a regular basis. We are looking at using other techniques in the future to guide people around the Arboretum, such as way marking, smart phone applications.

You can find copies of Loudon's work '*Arboretum et Fructicetum Britannicum*' and original copies of the 1840 catalogue in the Local Studies Library (01332 642240, minicom 01332 380712). Other interesting exhibits about the Arboretum can be found in Grove Lodge. Please ask the on-site management team for more details or visit the website at [www.derby.gov.uk](http://www.derby.gov.uk)

You may find a reference book such as the Collins '*Guide to Trees of Britain and Northern Europe*' useful in identifying some of the trees.

The Arboretum has been split into five distinct areas (A to E, as shown below) to help you find the trees. Those on the tree trail leaflet are shown as being 1 to 25, the remaining trees start at number 26.

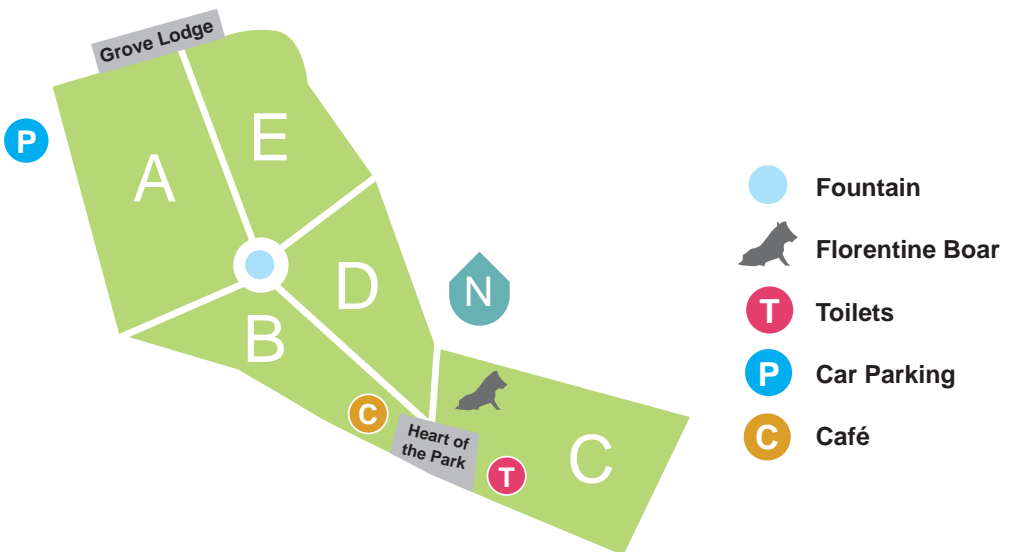

# Area A

10 A catalogue of trees in Derby Arboretum

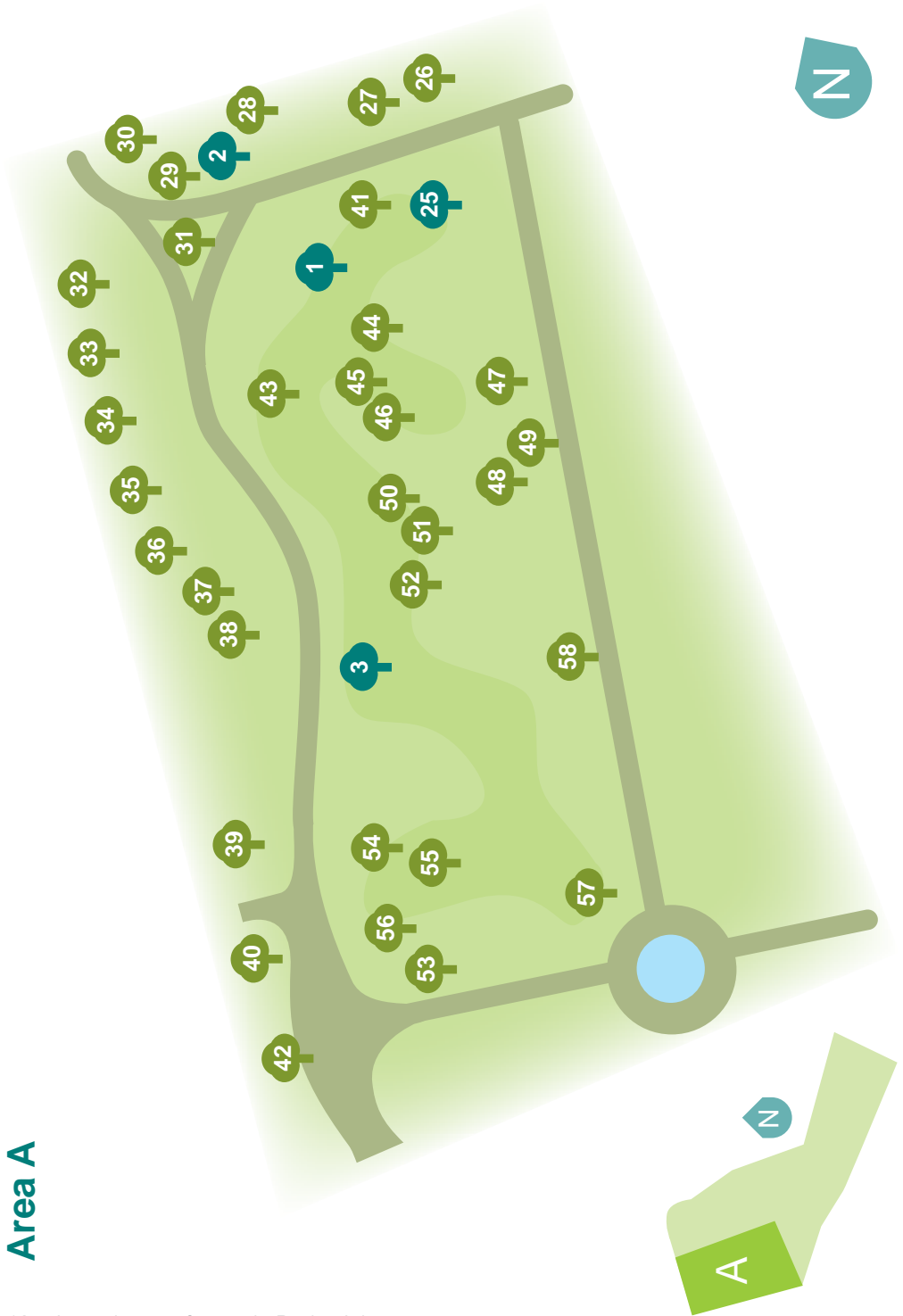

| Tree No. | Family           | Common name           | Genus     | Species       | Variety        | Approx. Date of introduction | Country of origin |
|----------|------------------|-----------------------|-----------|---------------|----------------|------------------------------|-------------------|
| 01       | Magnoliaceae     | Cucumber tree         | Magnolia  | acuminata     |                | 1736                         | E. & S. USA       |
| 02       | Aceraceae        | Red maple             | Acer      | rubrum        |                | 1656                         | N.America         |
| 03       | Tiliaceae        | Caucasian lime        | Tilia     | x euchlora    |                | 1860                         | Caucasus          |
| 25       | Platanaceae      | London plane          | Platanus  | x hispanica   |                | 1650                         | S. Europe         |
| 26       | Ulmaceae         | Camperdown elm        | Ulmus     | glabra        | 'Camperdownii' | c.1850                       | Garden var.       |
| 27       | Hippocastanaceae | Red horse chestnut    | Aesculus  | x carnea      |                | 1820                         | Germany           |
| 28       | Rosaceae         | Pillar crab           | Malus     | tschonoskii   |                | 1897                         | Japan             |
| 29       | Rosaceae         | Japanese cherry       | Prunus    |               | 'Kanzan'       | 1913                         | Japan             |
| 30       | Aceraceae        | Norway maple          | Acer      | platanoides   |                | 1683                         | Scandinavia       |
| 31       | Magnoliaceae     | Yulan lily tree       | Magnolia  | denudata      |                | 1789                         | China             |
| 32       | Tiliaceae        | Silver pendent lime   | Tilia     | 'Petolaris'   |                | 1880                         | Garden var.       |
| 33       | Rosaceae         | Pissard's plum        | Prunus    | cersifera     | 'Pissardii'    | 1880                         | Persia            |
| 34       | Carpinaceae      | Fastigate hornbeam    | Carpinus  | betulus       | 'Fastigiata'   | c. 1883                      | Garden var.       |
| 35       | Platanaceae      | London plane          | Platanus  | x hispanica   |                | 1650                         | S. Europe         |
| 36       | Salicaceae       | Upright white poplar  | Populus   | alba          | 'Pyramidalis'  | c1841                        | Garden var.       |
| 37       | Tiliaceae        | Common lime           | Tilia     | x europaea    |                | Native                       | Europe            |
| 38       | Hippocastanaceae | Horse chestnut        | Aesculus  | hippocastanum |                | 1616                         | Greece & Albania  |
| 39       | Rosaceae         | Hybrid cockspur thorn | Crataegus | x lavellei    |                | 1880                         | Garden var.       |
| 40       | Platanaceae      | London plane          | Platanus  | x hispanica   |                | 1650                         | S. Europe         |
| 41       | Magnoliaceae     | Southern magnolia     | Magnolia  | grandiflora   |                | 1734                         | S.E USA           |
| 42       | Salicaceae       | Lombardy poplar       | Populus   | nigra         | Italica'       | 1758                         | Italy             |
| 43       | Rosaceae         | Wild cherry           | Prunus    | avium         |                | Native                       | Europe            |
| 44       | Aceraceae        | Amur maple            | Acer      | ginnala       |                | 1860                         | China             |
| 45       | Aceraceae        | Japanese maple        | Acer      | palmatum      |                | 1820                         | Japan             |
| 46       | Aceraceae        | Red maple             | Acer      | rubrum        |                | 1656                         | N.America         |



## Area A (continued)

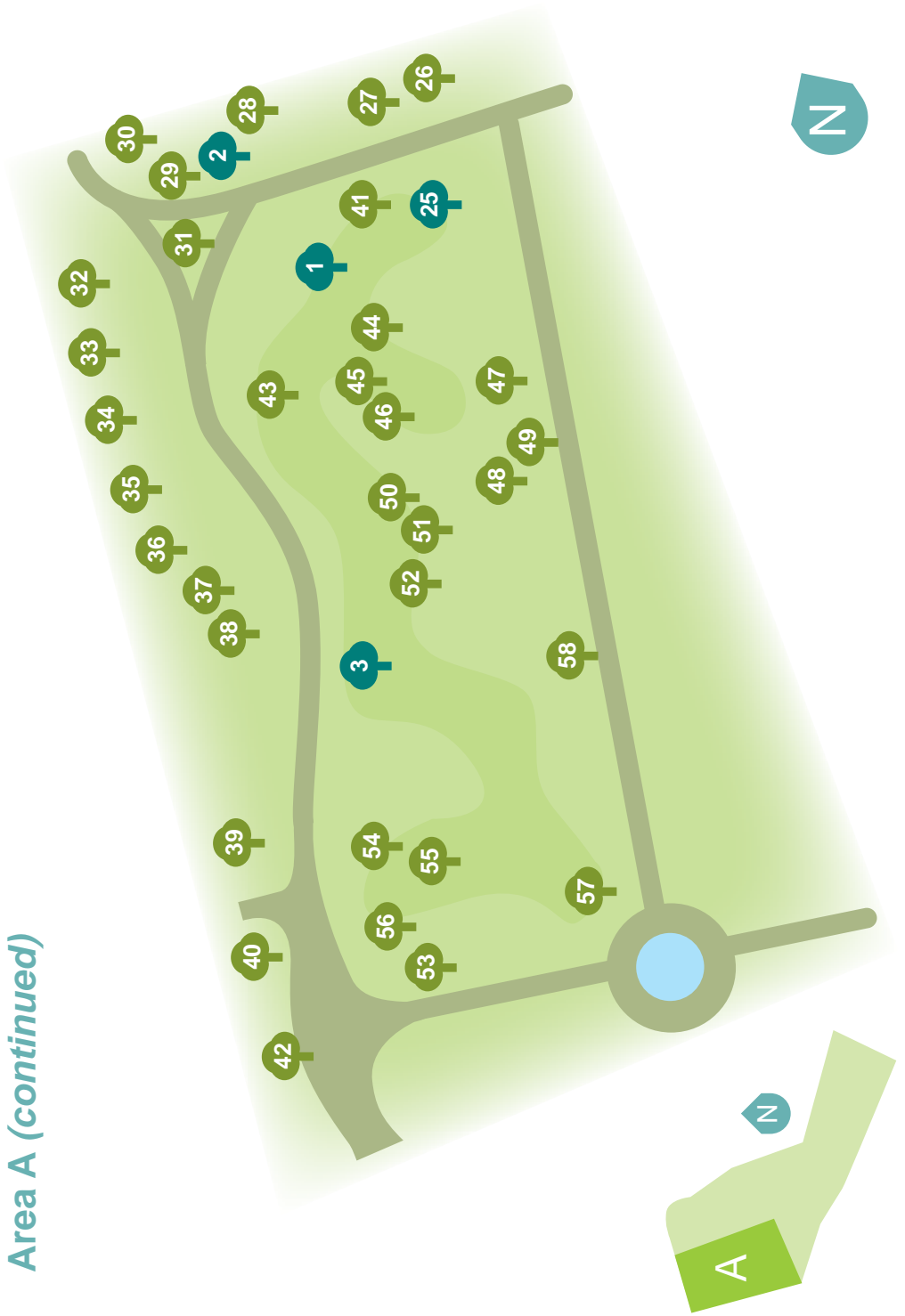

| Tree No. | Family           | Common name           | Genus        | Species         | Variety          | Approx. Date of introduction | Country of origin               |
|----------|------------------|-----------------------|--------------|-----------------|------------------|------------------------------|---------------------------------|
| 47       | Rosaceae         | Yoshino cherry        | Prunus       | yedoensis       |                  | 1902                         | Japan                           |
| 48       | Rosaceae         | Bird cherry           | Prunus       | padus           |                  | Native                       | Europe                          |
| 49       | Oleaceae         | Manna ash             | Fraxinus     | ornus           |                  | pre1700                      | S.Europe & W.Asia               |
| 50       | Tiliaceae        | Caucasian lime        | Tilia        | x euchlora      |                  | 1860                         | Caucasus                        |
| 51       | Hippocastanaceae | Indian horse chestnut | Aesculus     | indica          |                  | 1851                         | Himalayas                       |
| 52       | Hippocastanaceae | Yellow buckeye        | Aesculus     | flava           |                  | 1764                         | S.E USA                         |
| 53       | Aquifoliaceae    | Weeping holly         | Ilex         | x altaclarensis | 'Pendula'        |                              | Garden variety<br>China, Korea, |
| 54       | Sapindaceae      | Pride of India        | Koelreuteria | paniculata      |                  | 1763                         | Japan                           |
| 55       | Rosaceae         | Bird cherry           | Prunus       | padus           |                  | Native                       | Europe                          |
| 56       | Tiliaceae        | Common lime           | Tilia        | x europaea      |                  | Native                       | Europe                          |
| 57       | Aquifoliaceae    | Hedgehog holly        | Ilex         | aquifolium      | 'Ferox Argentea' |                              | Garden var.                     |
| 58       | Fagaceae         | Pedunculate oak       | Quercus      | robur           |                  | Native                       | Europe                          |

## Area B

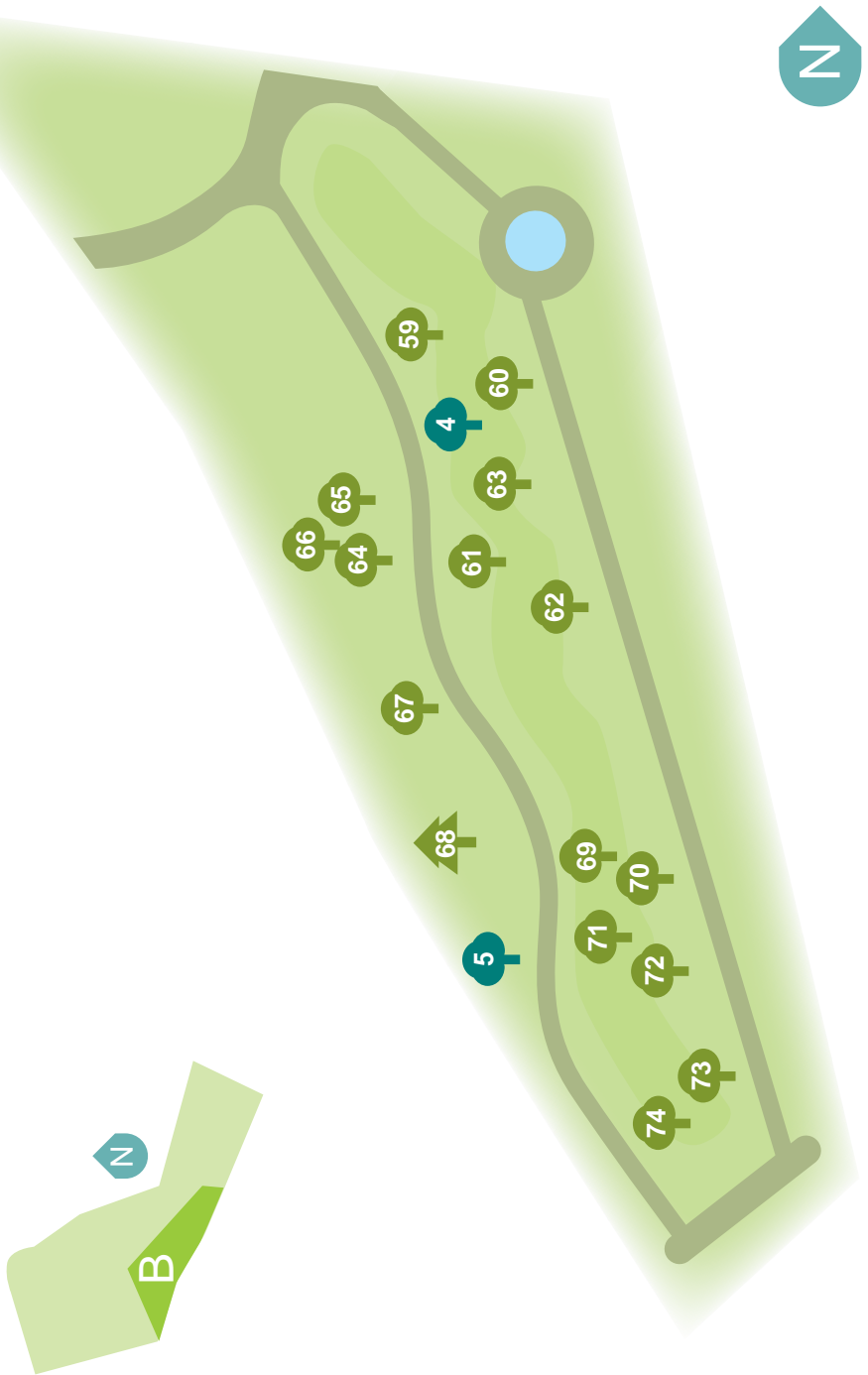



| Tree No. | Family        | Common name         | Genus             | Species         | Variety        | Approx. Date of introduction | Country of origin                  |
|----------|---------------|---------------------|-------------------|-----------------|----------------|------------------------------|------------------------------------|
| 4        | Leguminosae   | False acacia        | Robinia           | pseudoacacia    |                | c.1636                       | N.America                          |
| 5        | Ulmaceae      | Wych elm            | Ulmus             | glabra          |                | Native                       | Europe                             |
| 59       | Fagaceae      | Beech               | Fagus             | sylvatica       |                | Native                       | Europe                             |
| 60       | Aquifoliaceae | Highclere holly     | Ilex              | x alticolaensis |                |                              | Garden var.                        |
| 61       | Leguminosae   | Corkscrew Robinia   | Robinia           | pseudoacacia    | 'Tortuosa'     | 1880                         | Garden var.                        |
| 62       | Tiliaceae     | Silver pendent lime | Tilia             | 'Petolaris'     |                | 1560                         | Garden var.                        |
| 63       | Leguminosae   | Laburnum            | Laburnum          | anagyroides     |                | c.1700                       | C & S. Europe                      |
| 64       | Leguminosae   | Honey locust        | Gleditsia         | triacanthos     |                |                              | Mid West USA                       |
| 65       | Leguminosae   | Honey locust        | Gleditsia         | triacanthos     | 'Inermis'      |                              | Garden var.                        |
| 66       | Leguminosae   | Honey locust        | Gleditsia         | triacanthos     | 'Sunburst'     | 1953                         | Garden var.                        |
| 67       | Rosaceae      | Tibetan cherry      | Prunus            | serrula         |                | 1908                         | W. China                           |
| 68       | Cupressaceae  | Leyland cypress     | X Cupressocyparis | leylandii       |                | c.1870                       | Garden var.                        |
| 69       | Rosaceae      | Purple bird cherry  | Prunus            | padus           | 'Purple Queen' | 1914                         | Garden var.<br>S. Europe & W. Asia |
| 70       | Leguminosae   | Judas tree          | Cercis            | siliquastrum    |                | 1500s                        | Asia                               |
| 71       | Tiliaceae     | Caucasian lime      | Tilia             | x euchlora      |                | 1860                         | Caucasus                           |
| 72       | Tiliaceae     | Silver pendent lime | Tilia             | 'Petolaris'     |                | 1880                         | Garden var.                        |
| 73       | Rosaceae      | Japanese cherry     | Prunus            |                 | 'Kanzan'       | 1913                         | Japan                              |
| 74       | Rosaceae      | Cockspur thorn      | Crataegus         | x prunifolia    |                | 1797                         | Europe                             |

# Area C



| Tree No. | Family        | Common name              | Genus           | Species         | Variety           | Approx. Date of introduction | Country of origin     |
|----------|---------------|--------------------------|-----------------|-----------------|-------------------|------------------------------|-----------------------|
| 6        | Fagaceae      | Copper beech             | Fagus           | sylvatica       | 'Purpurea'        | Native                       | Garden var.           |
| 7        | Rosaceae      | Wild pear                | Pyrus           | communis        |                   | long cultivated              | Europe                |
| 8        | Rosaceae      | Red oak                  | Quercus         | rubra           |                   | 1724                         | E. N. America         |
| 9        | Aquifoliaceae | Highclere holly          | Ilex            | x altaclarensis |                   | 1880                         | Garden var.           |
| 75       | Tiliaceae     | Common lime              | Tilia           | x europaea      |                   | Native                       | Europe                |
| 76       | Rosaceae      | Scarlet Midland hawthorn | Crataegus       | laevigata       | 'Paul's Scaffold' | 1858                         | Garden var.           |
| 77       | Rosaceae      | Pissard's plum           | Prunus          | cersifera       | 'Nigra'           | 1880                         | Persia                |
| 78       | Rosaceae      | Callery's pear           | Pyrus           | calleryana      | 'Chanticleer'     |                              | Garden var.           |
| 79       | Rosaceae      | Medlar thorn             | XCrataemespilus | grandiflora     |                   | 1800                         | Europe                |
| 80       | Rosaceae      | Japanese cherry          | Prunus          | 'Accolade'      |                   | 1950s                        | Garden var.           |
| 81       | Rosaceae      | Hawthorn                 | Crataegus       | monogyna        |                   | Native                       | Europe                |
| 82       | Aceraceae     | Cappadocian maple        | Acer            | cappadocicum    |                   | 1838                         | Caucasus              |
| 83       | Rosaceae      | Swedish whitebeam        | Sorbus          | intermedia      |                   | long cultivated              | Scandinavia           |
| 84       | Fagaceae      | Antarctic beech          | Nothofagus      | antarctica      |                   | 1830                         | Chile                 |
| 85       | Araliaceae    | Devils walking stick     | Aralia          | spinosa         |                   | 1688                         | SE USA                |
| 86       | Rosaceae      | Japanese crab apple      | Malus           | floribunda      |                   | 1862                         | Japan                 |
| 87       | Rosaceae      | Japanese cherry          | Prunus          | 'Shirotae'      |                   |                              | Japan                 |
| 88       | Aquifoliaceae | Variiegated holly        | Ilex            | aquifolium      | 'Silver Queen'    | 1770                         | Garden var.           |
| 89       | Fagaceae      | Pin oak                  | Quercus         | palustris       |                   |                              | N.USA                 |
| 90       | Salicaceae    | White poplar             | Populus         | alba            |                   | long cultivated              | C. Europe             |
| 91       | Rosaceae      | Medlar                   | Mespilus        | germanica       |                   | long cultivated              | S. Europe             |
| 92       | Taxaceae      | Common yew               | Taxus           | baccata         |                   | Native                       | Europe                |
| 93       | Fagaceae      | Hungarian oak            | Quercus         | frainetto       |                   | 1838                         | Balkans & Hungary     |
| 94       | Fagaceae      | Turkey oak               | Quercus         | cerris          |                   | 1735                         | S. Europe & S.W. Asia |
| 95       | Aceraceae     | Amur maple               | Acer            | ginnala         |                   | 1860                         | China                 |
| 96       | Rosaceae      | Medlar                   | Mespilus        | germanica       |                   | long cultivated              | S. Europe             |



## Area D



| Tree No. | Family       | Common name         | Genus       | Species      | Variety | Approx. Date of introduction | Country of origin |
|----------|--------------|---------------------|-------------|--------------|---------|------------------------------|-------------------|
| 10       | Fagaceae     | Holm oak            | Quercus     | ilex         |         | c.1500                       | S.Europe          |
| 11       | Tiliaceae    | Silver pendent lime | Tilia       | 'Petiolaris' |         | 1880                         | Garden var.       |
| 12       | Oleaceae     | Narrow leaved ash   | Fraxinus    | angustifolia |         | c1800                        | S.Europe          |
| 97       | Rosaceae     | Tree cotoneaster    | Cotoneaster | frigidus     |         | 1824                         | Himalayas         |
| 98       | Tiliaceae    | Silver pendent lime | Tilia       | 'Petiolaris' |         | 1880                         | Garden var.       |
| 99       | Fagaceae     | Oriental beech      | Fagus       | orientalis   |         | 1904                         | Asia minor        |
| 100      | Bignoniaceae | Indian bean tree    | Catalpa     | bignonioides |         | 1726                         | S. USA            |

# Area E

20 A catalogue of trees in Derby Arboretum

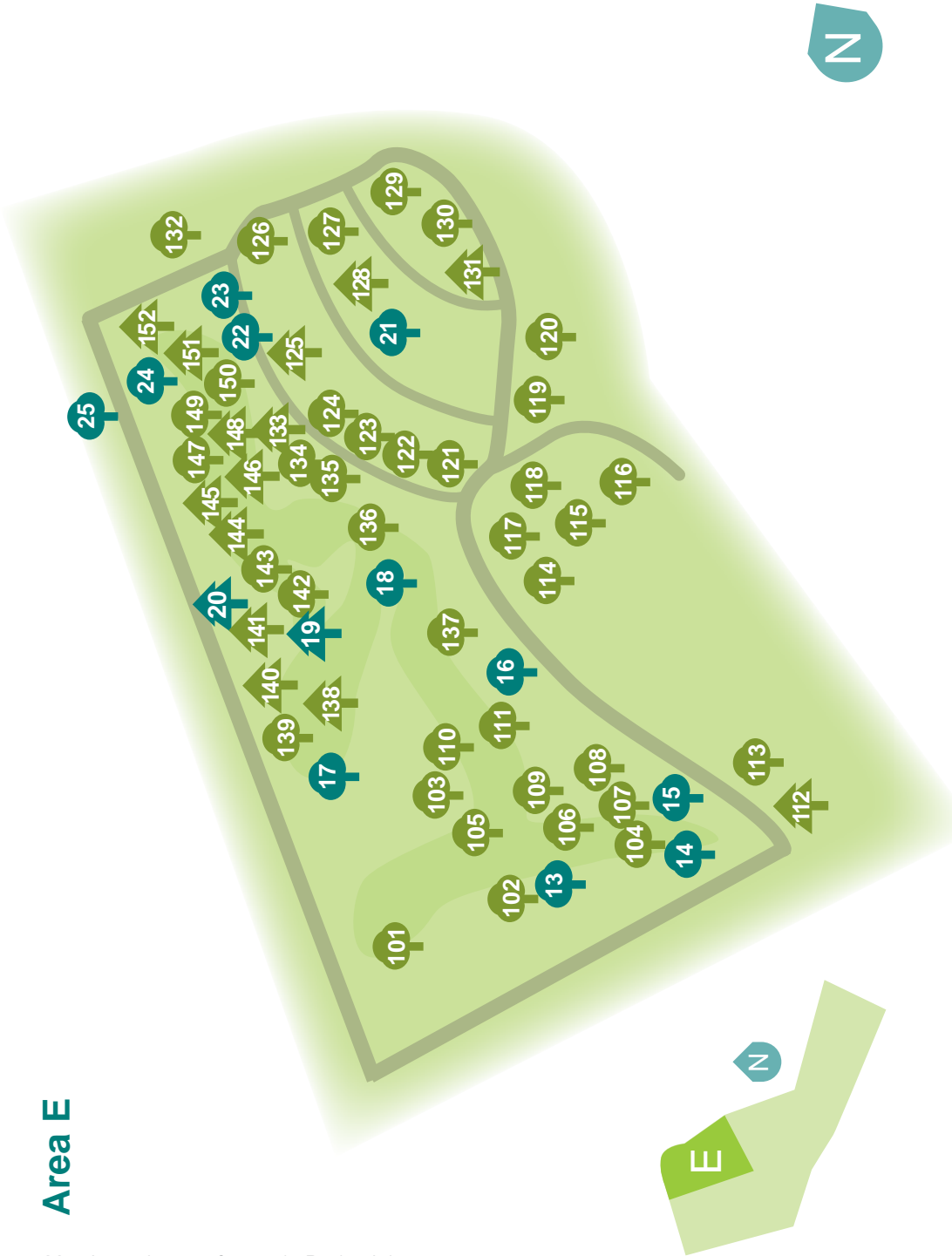

| Tree No. | Family        | Common name       | Genus        | Species      | Variety   | Approx. Date of introduction | Country of origin     |
|----------|---------------|-------------------|--------------|--------------|-----------|------------------------------|-----------------------|
| 13       | Moraceae      | Black mulberry    | Morus        | nigra        |           | c1500                        | W. Asia               |
| 14       | Juglandaceae  | Black walnut      | Juglans      | nigra        |           | 1656                         | USA                   |
| 15       | Juglandaceae  | Caucasian wingnut | Pterocarya   | fraxinifolia |           | 1782                         | Caucasus              |
| 16       | Bignoniaceae  | Northern catalpa  | Catalpa      | speciosa     |           | 1880                         | C. USA                |
| 17       | Tiliaceae     | American lime     | Tilia        | americana    |           | 1752                         | Central USA           |
| 18       | Corylaceae    | Turkish hazel     | Corylus      | colurna      |           | 1582                         | W. Asia               |
| 19       | Pinaceae      | Grand fir         | Abies        | grandis      |           | 1832                         | N.W. America          |
| 20       | Pinaceae      | Monterey pine     | Pinus        | radiata      |           | 1833                         | California            |
| 21       | Fagaceae      | Sweet chestnut    | Castanea     | sativa       |           | long cultivated              | S. Europe             |
| 22       | Magnoliaceae  | Tulip tree        | Liriodendron | tulipifera   |           | 1688                         | E. N. America         |
| 23       | Oleaceae      | Weeping ash       | Fraxinus     | excelsior    | 'Pendula' | Native                       | Garden var.           |
| 24       | Simabrouaceae | Tree of heaven    | Ailanthus    | altissima    |           | 1751                         | N. China              |
| 25       | Platanaceae   | London plane      | Platanus     | x hispanica  |           | 1650                         | S. Europe             |
| 102      | Nyssaceae     | Tupelo            | Nyssa        | sylvatica    |           | 1750                         | E. & S. USA           |
| 103      | Moraceae      | White mulberry    | Morus        | alba         |           | 1596                         | C. Asia & China       |
| 104      | Juglandaceae  | Caucasian wingnut | Pterocarya   | fraxinifolia |           | 1782                         | Caucasus              |
| 105      | Juglandaceae  | Black walnut      | Juglans      | nigra        |           | 1656                         | USA                   |
| 106      | Ulmaceae      | Hackberry         | Celtis       | occidentalis |           | 1636                         | E. N. America         |
| 107      | Ulmaceae      | Nettle tree       | Celtis       | australis    |           | 1796                         | Europe & Asia         |
| 108      | Salicaceae    | Osier             | Salix        | viminalis    |           | Native                       | Europe                |
| 109      | Salicaceae    | Goat willow       | Salix        | caprea       |           | Native                       | Europe<br>E and C. N. |
| 110      | Aceraceae     | Silver maple      | Acer         | saccharinum  |           | 1725                         | America               |
| 111      | Juglandaceae  | Common walnut     | Juglans      | regia        |           | long cultivated              | S. Europe             |
| 112      | Pinaceae      | Larch             | Larix        | decidua      |           | 1620                         | Europe                |
| 113      | Simabrouaceae | Tree of heaven    | Ailanthus    | altissima    |           | 1751                         | N. China              |

## Area E (continued)



| Tree No. | Family         | Common name         | Genus       | Species         | Variety        | Approx. Date of introduction | Country of origin   |
|----------|----------------|---------------------|-------------|-----------------|----------------|------------------------------|---------------------|
| 114      | Aceraceae      | Sycamore            | Acer        | pseudoplatanus  |                | long cultivated              | C. Europe           |
| 115      | Rosaceae       | Wild cherry         | Prunus      | avium           |                | Native                       | Europe              |
| 116      | Leguminosae    | False acacia        | Robinia     | pseudoacacia    |                | c.1636                       | N.America           |
| 117      | Corylaceae     | Turkish hazel       | Corylus     | colurna         |                | 1582                         | W. Asia             |
| 118      | Fagaceae       | Copper beech        | Fagus       | sylvatica       | 'Purpurea'     | Native                       | Garden var.         |
| 119      | Aceraceae      | Sycamore            | Acer        | pseudoplatanus  |                | long cultivated              | C. Europe           |
| 120      | Aquifoliaceae  | Highclere holly     | Ilex        | x altaclarensis |                | 1880                         | Garden var.         |
| 121      | Tiliaceae      | Silver pendent lime | Tilia       | 'Petiolaris'    |                | 1880                         | Garden var.         |
| 122      | Juglandaceae   | Common walnut       | Juglans     | regia           |                | long cultivated              | S. Europe           |
| 123      | Rosaceae       | Wild cherry         | Prunus      | avium           |                | Native                       | Europe              |
| 124      | Tiliaceae      | Common lime         | Tilia       | x europaea      |                | Native                       | Europe              |
| 125      | Taxodiaceae    | Swamp cypress       | Taxodium    | distichum       |                | 1640                         | S.USA               |
| 126      | Aquifoliaceae  | Common holly        | Ilex        | aquifolium      |                | Native                       | Europe              |
| 128      | Araucariaceae  | Monkey puzzle       | Araucaria   | araucana        |                | 1795                         | Chile               |
| 129      | Hamamelidaceae | Sweet gum           | Liquidambar | styraciflua     |                | 1681                         | E. & S. USA         |
| 130      | Fagaceae       | Sweet chestnut      | Castanea    | sativa          |                | long cultivated              | S. Europe           |
| 131      | Taxaceae       | Common yew          | Taxus       | baccata         |                | Native                       | Europe              |
| 132      | Aquifoliaceae  | Variiegated holly   | Ilex        | aquifolium      | 'Silver Queen' |                              | Garden var.         |
| 133      | Pinaceae       | Cedar of Lebanon    | Cedrus      | libani          |                | 1638                         | Syria, Lebanon      |
| 134      | Aceraceae      | Purple maple        | Acer        | platanoides     | 'Schwedleri'   | 1864                         | Garden var.         |
| 135      | Hamamelidaceae | Sweet gum           | Liquidambar | styraciflua     |                | 1681                         | E. & S. USA         |
| 136      | Carpinaceae    | Hop hornbeam        | Ostrya      | carpinifolia    |                | 1724                         | S. Europe & W. Asia |
| 137      | Aceraceae      | Purple maple        | Acer        | platanoides     | 'Crimson king' | 1946                         | Garden var.         |
| 138      | Ginkgoaceae    | Maidenhair tree     | Ginkgo      | biloba          |                | 1758                         | China               |
| 139      | Moraceae       | Osage orange        | Maclura     | pomifera        |                | 1818                         | S. & C. USA         |



## Area E (continued)



| Tree No. | Family       | Common name            | Genus     | Species    | Variety      | Approx. Date of introduction | Country of origin              |
|----------|--------------|------------------------|-----------|------------|--------------|------------------------------|--------------------------------|
| 140      | Pinaceae     | Austrian pine          | Pinus     | nigra      | var.nigra    | 1835                         | C. Europe                      |
| 141      | Taxaceae     | Irish yew              | Taxus     | baccata    | 'Fastigiata' | 1780                         | Ireland                        |
| 142      | Araliaceae   | Japanese Angelica Tree | Aralia    | elata      |              | 1830                         | Japan                          |
| 143      | Corylaceae   | Turkish hazel          | Corylus   | colurna    |              | 1582                         | W. Asia                        |
| 144      | Pinaceae     | Corsican pine          | Pinus     | nigra      | ssp. Laricio | 1759                         | Corsica & S. Ital              |
| 145      | Pinaceae     | Lodgepole pine         | Pinus     | contorta   |              | 1831                         | W. N. America                  |
| 146      | Pinaceae     | Noble fir              | Abies     | procera    |              | 1830                         | W.USA                          |
| 147      | Rosaceae     | Japanese cherry        | Prunus    |            | 'Kanzan'     | 1913                         | Japan                          |
| 148      | Pinaceae     | Norway spruce          | Picea     | abies      |              | 1500                         | N. & C. Europe                 |
| 149      | Betulaceae   | Italian alder          | Alnus     | cordata    |              | 1820                         | Italy                          |
| 150      | Rosaceae     | Wild cherry            | Prunus    | avium      |              | Native                       | Europe                         |
| 151      | Cupressaceae | Pencil cedar           | Juniperus | virginiana |              | 1664                         | E & C N.America<br>Europe & N. |
| 152      | Cupressaceae | Common juniper         | Juniperus | communis   |              | Native                       | America                        |

# How to find Derby Arboretum



## Further information

Contact the parks management team on 01332 64155, minicom 01332 256666 or email: [parkadmin@derby.gov.uk](mailto:parkadmin@derby.gov.uk)

During office hours, please telephone the on-site management team on 01332 292612, or email: [derby.arboretum@derby.gov.uk](mailto:derby.arboretum@derby.gov.uk)

For urgent tree problems out of office hours, please contact 01332 256060 minicom 01332 256666.

## Arboretum Park

- is wheelchair and pushchair accessible.
- welcomes dogs under control.
- has Car parking available at Grove Street (pay and display).

For bus services ring the Traveline on 0871 2002233.



The production of the labels and this booklet has been grant aided by the Monica Pilling Bequest through Derbyshire Historic Gardens Trust. For membership information telephone 01335 370495

We can supply this information in any other way style or language to help you access it.  
Phone 01332 292612, Minicom 01332 256666.

Polish

Aby ułatwić Państwu dostęp do tych informacji, możemy je Państwu przekazać w innym formacie, stylu lub języku.

Prosimy o kontakt: 01332 292612      Tel. tekstowy: 01332 256666

Punjabi

ਇਹ ਜਾਣਕਾਰੀ ਅਸੀਂ ਤੁਹਾਨੂੰ ਕਿਸੇ ਵੀ ਹੋਰ ਤਰੀਕੇ ਨਾਲ, ਕਿਸੇ ਵੀ ਹੋਰ ਰੂਪ ਜਾਂ ਬੋਲੀ ਵਿੱਚ ਦੇ ਸਕਦੇ ਹਾਂ, ਜਿਹੜੀ ਇਸ ਤੱਕ ਪਹੁੰਚ ਕਰਨ ਵਿੱਚ ਤੁਹਾਡੀ ਸਹਾਇਤਾ ਕਰ ਸਕਦੀ ਹੋਵੇ। ਕਿਰਪਾ ਕਰਕੇ ਸਾਡੇ ਨਾਲ ਟੈਲੀਫੋਨ 01332 292612 ਮਿਨੀਕਮ 01332 256666 ਤੇ ਸੰਪਰਕ ਕਰੋ।

Urdu

یہ معلومات ہم آپ کو کسی دیگر ایسے طریقے، انداز اور زبان میں مہیا کر سکتے ہیں جو اس تک رسائی میں آپ کی مدد کرے۔ براہ کرم 01332 292612 پر ہم سے رابطہ کریں۔ 01332 256666 منی کام

[www.derby.gov.uk](http://www.derby.gov.uk)



Printed on paper made from recycled material.